

### Full Overlay–Concealed Hinges

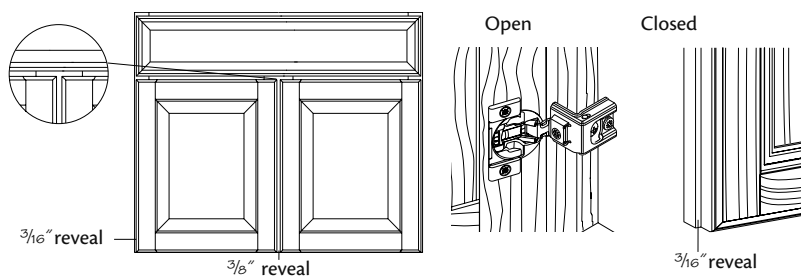

- Full Overlay doors leave  $\frac{3}{8}$ " of the cabinet's face frame exposed between doors
- Whisper Touch™ hinge features an integrated mechanism that closes doors softly and quietly and is adjustable six ways for perfect alignment
- The reveals shown here may vary slightly on some cabinets due to actual door/drawer front sizes used. Refer to the replacement door and drawer section of this book for actual door/drawer sizes for specific cabinets.
- **Note:** Door styles with square outside edges (including aluminum frame decorative doors) **cannot** be opened simultaneously on adjacent cabinets because the doors will rub together. This is a common occurrence due to the sizing of full overlay doors

### 1/2" Overlay–Concealed or Knife Hinge

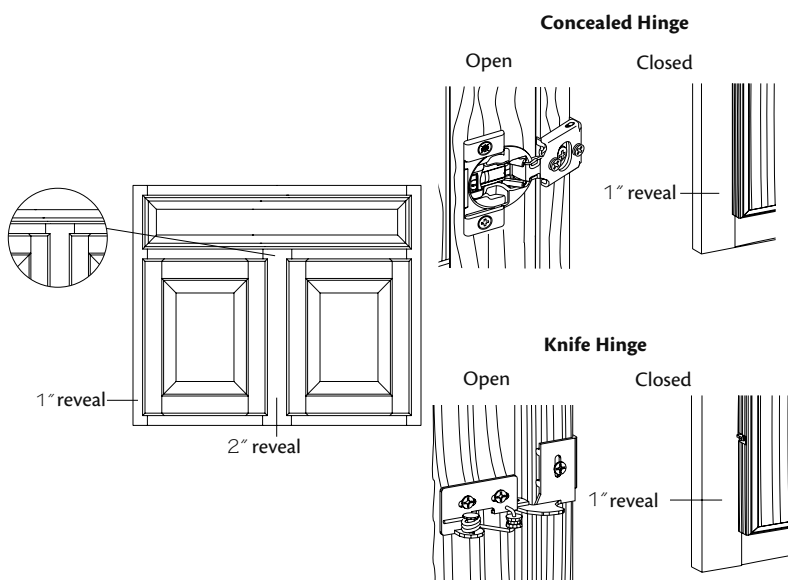

- 1/2" overlay doors leave 2" of the cabinet's face frame exposed between doors
- Whisper Touch™ hinge features an integrated mechanism that closes doors softly and quietly and is adjustable six ways for perfect alignment
- Knife hinge capable of opening 180°
- Knife hinges are **not** available on any full overlay door styles
- A knife hinge option is available on 1/2" overlay door styles (see list below)
- Knife Hinge is available in the following doorstyles: Gentry Cherry Roman–Half, Gentry Cherry Square–Half, Hanover and Wickstrom
- The reveals shown here may vary slightly on some cabinets due to actual door/drawer front sizes used. Refer to the replacement door and drawer section of this book for actual door/drawer sizes for specific cabinets.

## Cabinet Specifications

**KraftMaid Cabinetry** is also available in an All Plywood (APC) Option. See Construction Options section for a complete description.

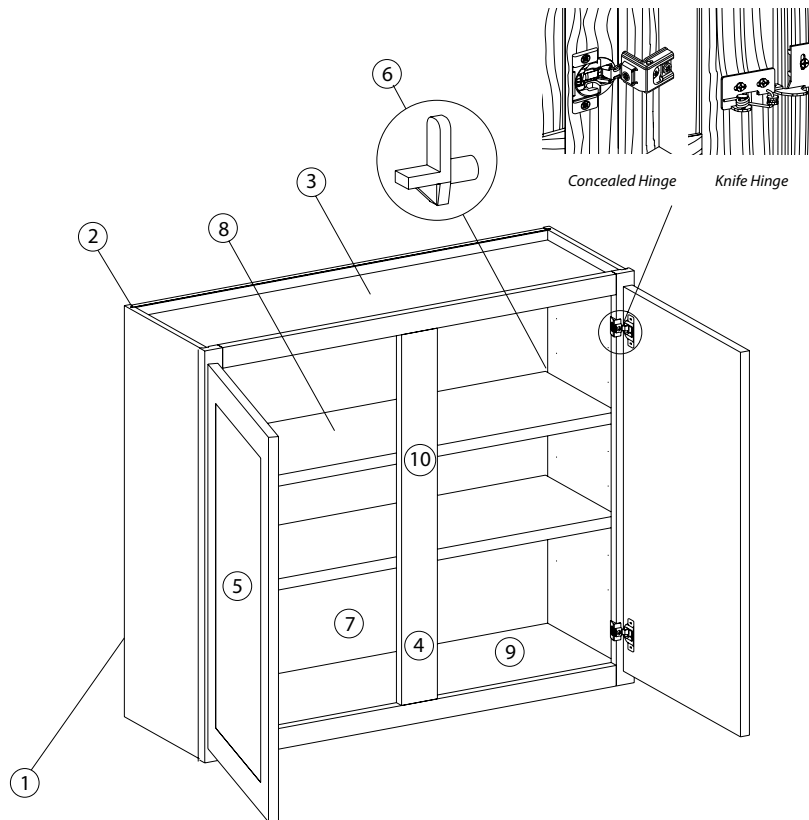

- (1) Viraguard clad back panel
- (2) 1/2" wood concealed hanging rail
- (3) 1/2" Natural Birch Viraguard clad ceiling panel
- (4) 3/4" solid hardwood, including but not limited to, Alder, Birch, Cherry, Hickory, Maple and Oak front frame constructed using industrial grade glue and hardened steel fasteners. Front frame species complements selected door style.
- (5) Extensive and unique door style and wood species selection in Alder, Birch, Cherry, EverCore™, Hickory, Maple and Oak. Solid and wood veneer construction available. Also available in Laminate, High-gloss Laminate and Woodgrain Laminate.
- (6) Satin chrome shelf rests for all kitchen wall and furniture cabinets. Easily adjustable positive locking shelf clips for all base, tall and vanity cabinets.
- (7) Natural Birch Viraguard interior.
- (8) 3/4" fully adjustable Natural Birch Viraguard clad shelving standard feature in wall, base and tall cabinets.
- (9) 1/2" Natural Birch Viraguard clad cabinet bottom
- (10) 14-step DuraKraft Plus™ furniture process featuring hand-wiped stain with one of the finest wood finishes available in the cabinet industry
- (11) Full-depth I-beam braces provide stability and convenient anchor points for countertop
- (12) 3/8" Natural Birch Viraguard clad base back panel
- (13) 3/4" solid wood base installation rail
- (14) Standard drawer runner suspension system features smooth, ball bearing operation with a 90 lb. load capacity. Whisper Touch™ runner has an integrated drawer buffer that engages two inches from closing and applies resistance, giving a soft, controlled closing.
- (15) 3/4" full-depth solid wood dovetailed drawer featuring four sided construction and 3/16" plywood bottom
- (16) Self-closing, concealed, wrap-around adjustable or optional knife hinges (KH)
- (17) Full-depth, fully adjustable 3/4" Natural Birch Viraguard clad shelving
- (18) Drawer heads are solid hardwood or laminate to complement each door style.
- (19) Fully closed toe space area.
- (20) 1/2" end panels with woodgrain Viraguard interior and matching exterior. Also available with optional 1/2" or 3/4" plywood end panels. Woodgrain Viraguard interior or wood veneer interior available. Unless noted, plain sawn end panels will be supplied for quartersawn door styles.
- (21) Standard drawer boxes are 4 1/2" high
- Viraguard is the tradename of our printed wood grain laminate
- **Note:** Unless noted, cabinet depth does **not** include doors or drawer fronts
- **Note:** Please contact Customer Care if your design requires verification of product specifications

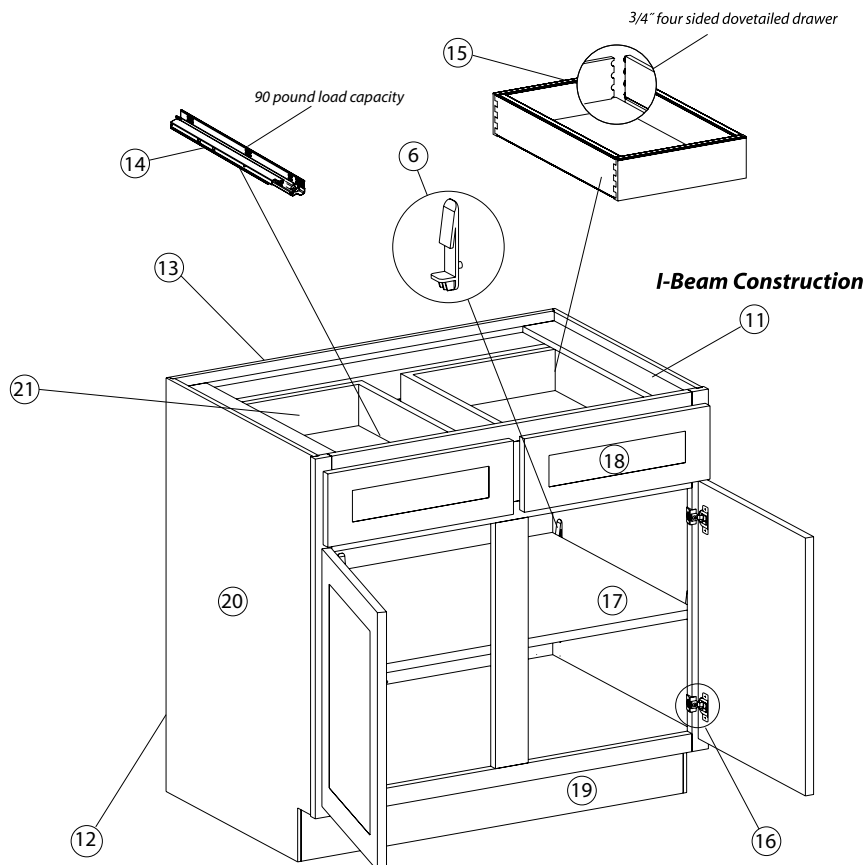

# Construction Options

## Construction Options and Modifications

- ❖ Included as standard
- Available with an upcharge
- ☆ Available with exceptions
- (Blank) **Not** available

PE	Plywood Ends
APC	All Plywood Construction
APFC	All Plywood Furniture Construction
FPEB	Furniture Plywood Ends
MI	Matching Interior
DE	Integrated Decorative End
OE	Operational End
RD	Reduced Depth
ID	Increased Depth
IF	Inverted Frame
TWR	Top Wide Rail
WR	Wide Bottom Rail
XS	Extended Stile
XSG	Integrated Extended Stile
GD	Glass Doors
RTK	Recessed Toe Kick
RTKP	Recessed Toe Kick Peninsula

Use the option availability chart at the right of each item to determine which construction options are available for your desired cabinet.

Material dimensions listed may vary slightly from actual dimensions of the product.

Specification subject to change without notice.

KraftMaid® Cabinetry Utilizes Some of the Best Materials Available to Build the Highest Quality Cabinets.

At KraftMaid® we continuously strive to provide products of the highest quality for all rooms of the home. In order to fulfill our commitment to quality, you may see some material changes in some of the plywood components that we use. The material changes will help reduce warping, expansion and contraction within the parts.

### What Is In Some Of Our Plywood?

Multiple layers of wood materials, including wood veneers and medium density fiberboard (MDF), are used to create a hybrid product containing the following benefits:

- Improved Strength and Finish Quality: Reduces expansion or contraction, which is better for a smooth, quality finish. This process also produces a more rigid product.
- Environmentally Friendly: Supports CARB II standards. (CARB, or California Air Resource Board, is a control measure for reduced formaldehyde emissions from composite wood products.)

Regardless of the wood material used in the various applications of our All Plywood Construction, you can feel confident that KraftMaid Cabinetry always uses some of the highest quality materials available to help ensure durable and long-lasting cabinets.

**Note:** According to the Department of Commerce, the core of hardwood and decorative plywood consists of a layer or layers of one or more material(s) that are situated between the face and back veneers. The core may be composed of a range of materials, including but **not** limited to veneers, particleboard, engineered wood and medium density fiberboard (MDF).

## Plywood Ends

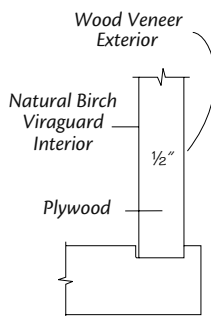

- PE** Full Kitchens
- PEB** Individual Cabinets

- This construction option affects end panels only
- Available for full or partial kitchen orders
- 1/2" plywood end panels are available for most cabinets
- Consult the Plywood Ends (PE) option box for your desired cabinet
- End panels only are 1/2" plywood with wood veneer exterior and Natural Birch Viraguard interior
- Shelves, ceilings and floors are engineered wood with Viraguard
- To order a full kitchen with Plywood Ends, use PE in the header of your order
- To order individual line items with Plywood Ends, dash each line item with PEB; Order Example: W3030-PEB
- Unless noted, plain sawn end panels will be supplied for quartersawn door styles
- Plywood End Panels do **not** receive glaze detailing
- Painted hardwood supplied for EverCore™

●	PE
	APC
	APFC
	FPEB
	MI
	DE
	OE
	RD
	ID
	IF
	TWR
	WR
	XS
	XSG
	GD
	RTK
	RTKP

## All Plywood Construction with 1/2" End Panels

### APC Full Kitchens

#### AP Individual Cabinets

- This construction option is available for full or partial kitchen orders
- All Plywood Construction (APC) option with 1/2" End Panels is available for most cabinets
- Consult All Plywood Construction (APC) option box for your desired cabinet construction
- This All Plywood option features:
  - 1/2" plywood floors, ceilings, end panels, I-beams and toe kicks
  - 3/4" plywood base, wall and tall shelves
  - 3/8" plywood base back panel
  - 3/16" plywood wall back panel and drawer bottoms
  - Hanging rail may be plywood or solid wood
  - Toe kick support blocks are **not** plywood
- Unless noted, plain sawn end panels will be supplied for quartersawn door styles
- Plywood End Panels do **not** receive glaze detailing
- Note:** To get All Plywood Construction on individual cabinets, each line must be dashed with AP. Order Example: W3030-AP
- Note:** To get All Plywood Construction with 3/4" (Furniture) Plywood Ends use APFC with APC. Order Example W3030BUTT-APFC, B12L-APFC (Refer to the APFC section for additional details on this option)
- Note:** To get All Plywood Construction with Matching Interior on individual cabinets use MIP. Order Example W3030BUTT-MIP, B12L-MIP (Refer to the MIP section for additional details on this option)
- Note:** To get All Plywood Construction with 3/4" (Furniture) Plywood Ends and Matching Interior on individual cabinets use MIAPFC. Order Example W3030BUTT-MIAPFC, B12L-MIAPFC (Refer to the MIAPFC section for additional details on this option)

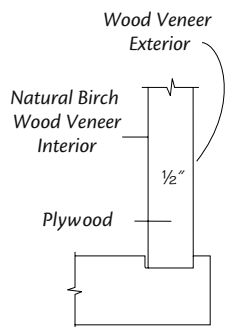

PE
● APC
APFC
FPEB
MI
DE
OE
CW
RD
ID
CH
IF
TWR
WR
XS
XSG
GD
RTK
RTKP

## All Plywood Construction with 3/4" (Furniture) End Panels

### APFC Individual Cabinets

- This construction option affects end panels only
- An All Plywood Construction with 3/4" (Furniture) End Panels option is available for most cabinets
- Consult All Plywood Furniture Construction option box (APFC) for your desired cabinet
- This All Plywood option features:
  - 3/4" plywood end panels
  - 1/2" plywood floors, ceilings, I-beams and toe kicks
  - 3/4" plywood base, wall and tall shelves
  - 3/8" plywood base and tall back panel
  - 3/16" plywood wall back panel, furniture back panel and drawer bottoms
  - Hanging rail may be plywood or solid wood
  - Toe kick support blocks are **not** plywood
- Unless noted, plain sawn end panels will be supplied for quartersawn door styles
- Plywood End Panels do **not** receive glaze detailing
- Painted hardwood supplied for EverCore™
- Note:** To get All Plywood Construction with 3/4" (Furniture) Plywood Ends on individual cabinets use APFC. Order Example W3030BUTT-APFC, B12L-APFC

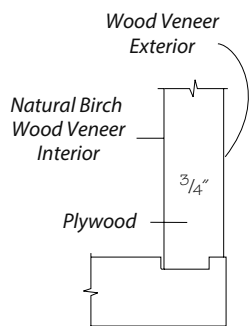

PE
APC
● APFC
FPEB
MI
DE
OE
CW
RD
ID
CH
IF
TWR
WR
XS
XSG
GD
RTK
RTKP

## Furniture Plywood Ends

### FPEB Individual Cabinets

- This construction option affects end panels only
- 3/4" Furniture Plywood End (FPEB) panels are available for most cabinets
- Consult Furniture Plywood Ends (FPEB) option box for your desired cabinet
- End panels only are 3/4" plywood with wood veneer exterior and Natural Birch Viraguard interior
- Shelves, ceilings and floors are engineered wood with Viraguard
- To order individual line items with Furniture Plywood Ends, dash each line item with FPEB; Order Example: W3030-FPEB, WEP3-30L-FPEB
- Unless noted, plain sawn end panels will be supplied for quartersawn door styles
- Plywood End Panels do **not** receive glaze detailing
- Painted hardwood supplied for EverCore™
- Note:** To get All Plywood Construction with 3/4" (Furniture) Plywood Ends use APFC with APC. Order Example W3030BUTT-APFC, B12L-APFC (Refer to the APFC section for additional details on this option)

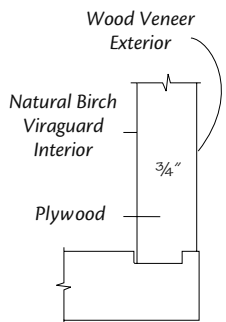

PE
APC
APFC
● FPEB
MI
DE
OE
CW
RD
ID
CH
IF
TWR
WR
XS
XSG
GD
RTK
RTKP

## Matching Interior Standard Construction–Viraguard

### MIV Individual Cabinets

- A Matching Interior option is recommended for all cabinets having glass doors
- Consult Matching Interior (MI) option box for availability for your desired cabinet
- If an item shows MI as standard in the option boxes, the matching interior material will be Viraguard unless that item's standard construction is All Plywood (APC), Wood Veneer or Furniture Plywood Ends (FPEB, APFC). This includes cabinets ordered as unfinished
- Inside of face frame is unfinished
- This option includes:
  - 1/2" end panels with matching Viraguard exterior and interior
  - 3/4" matching Viraguard shelves on satin chrome furniture shelf rests
  - Matching Viraguard for ceilings and floors
- You **must** use MIP, MIFP or MIAPFC to get a wood veneer matching interior
- Unless noted, plain sawn end panels will be supplied for quartersawn door styles
- Natural Birch and Natural Maple door styles with standard end panels are supplied standard with a Natural Birch Viraguard interior. It is **not** necessary to order Matching Interior.
- Painted hardwood supplied for EverCore™

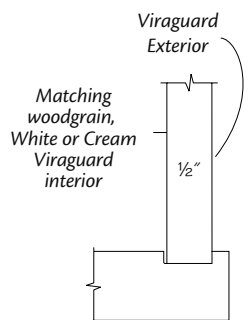

PE
APC
APFC
FPEB
● MI
DE
OE
CW
RD
ID
CH
IF
TWR
WR
XS
XSG
GD
RTK
RTKP

## Matching Interior with 1/2" Plywood End Panels

### MIP Individual Cabinets

- A Matching Interior Plywood option is available for individual items in a kitchen
- A Matching Interior option is recommended for all cabinets having glass doors
- Consult Matching Interior (MI) option box for availability for your desired cabinet
- Inside of face frame is unfinished
- This option includes:
  - 1/2" plywood end panels with matching wood veneer exterior and interior
  - 3/4" plywood shelves with matching wood veneer on satin chrome shelf rests
  - 1/2" plywood with matching wood veneer for ceilings and floors
  - 3/8" plywood base and tall back panel with matching wood veneer
  - 3/16" plywood wall and furniture back panel
- To order individual line items with Matching Interior you **must** have each line item dashed with the appropriate codes MIP (Order Example: W3030-MIP, WEP3•30L-MIP)
- Unless noted, plain sawn end panels will be supplied for quartersawn door styles
- Painted hardwood supplied for EverCore™
- **Note:** To get Matching Interior Furniture Plywood Ends with All Plywood Construction use MIAPFC

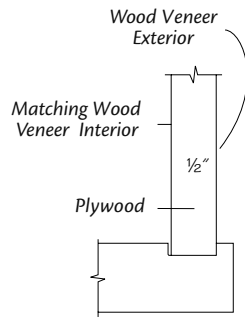

PE
APC
APFC
FPEB
● MI
DE
OE
RD
ID
IF
TWR
WR
XS
XSG
GD
RTK
RTKP

## Matching Interior with 3/4" (Furniture) End Panels on All Plywood (APC) Orders

### MIAPFC Individual Cabinets

- A Matching Interior All Plywood Furniture option is available for individual items in a kitchen
- A Matching Interior option is recommended for all cabinets having glass doors
- Consult Matching Interior (MI) option box for availability for your desired cabinet
- Inside of face frame is unfinished
- This option includes:
  - 3/4" plywood end panels with matching wood veneer exterior and interior
  - 3/4" plywood shelves with matching wood veneer on satin chrome shelf rests
  - 1/2" plywood with matching wood veneer for ceilings and floors.
  - 3/8" plywood base and tall back panel with matching wood veneer
  - 3/16" plywood with matching wood veneer wall and furniture back panel
- To order a full kitchen with Matching Interior (MI), you **must** have each line item dashed with MIAPFC. Order Example: W3030-MIAPFC, WEP3•30L-MIAPFC
- Unless noted, plain sawn end panels will be supplied for quartersawn door styles
- Painted hardwood supplied for EverCore™

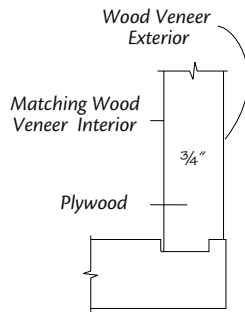

PE
APC
APFC
FPEB
● MI
DE
OE
RD
ID
IF
TWR
WR
XS
XSG
GD
RTK
RTKP

## Matching Interior with 3/4" Furniture Plywood End Panels

### MIFP Individual Cabinets

- A Matching Interior Furniture Plywood option is available for individual items in a kitchen
- A Matching Interior option is recommended for all cabinets having glass doors
- Consult Matching Interior (MI) option box for availability for your desired cabinet
- Inside of face frame is unfinished
- This option includes:
  - 3/4" plywood end panels with matching wood veneer exterior and interior
  - 3/4" engineered wood with matching wood veneer shelves on satin chrome shelf rests
  - 1/2" engineered wood with matching wood veneer for ceilings and floors
  - 3/16" plywood with matching wood veneer wall back panel
- To order individual line items with matching interior you **must** have each line item dashed with MIFP (Order Example: W3030BUTT-MIFP, WEP3•30L-MIFP)
- Unless noted, plain sawn end panels will be supplied for quartersawn door styles
- Painted hardwood supplied for EverCore™
- **Note:** To get Matching Interior Furniture Plywood Ends with All Plywood Construction use MIAPFC

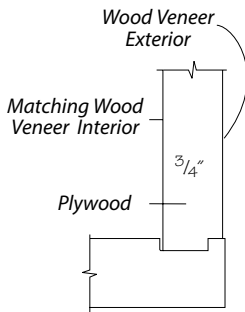

PE
APC
APFC
FPEB
● MI
DE
OE
RD
ID
IF
TWR
WR
XS
XSG
GD
RTK
RTKP

## Wood Veneer Construction

- KraftMaid® manufactures certain cabinets with Wood Veneer Construction standard. See specific cabinet for details. Depending on the item, this may consist of a solid hardwood, plywood or engineered wood core that has solid wood veneer on both sides and is finished to match

## Ordering Specifications for Plywood Options

	Entire Kitchen	Individual Cabinets
Plywood Ends	<b>PE</b> Use PE in the header of your written order. Every cabinet on this order will receive PE. Use Styles & Pricing in 20-20 to choose PE.	<b>PEB (Plywood Ends Both)</b> Each line item must be dashed with PEB. Order Example: W3030-PEB. In 20-20, use Attachments to apply PEB to each cabinet.
	<b>with Matching Interior</b> Matching Interior nomenclature is only available for individual cabinets. There is no nomenclature to order a full kitchen with Matching Interior Plywood. See individual cabinet instructions.	<b>MIP (Matching Interior Plywood)</b> Each line item must be dashed with MIP. Order Example: W3030-MIP. In 20-20, use Attachments to apply MIP to each cabinet.
Furniture Ends	Furniture Ends nomenclature is only available for individual cabinets. There is no nomenclature to order a full kitchen with Furniture Ends. See individual cabinet instructions.	<b>FPEB (Furniture Plywood Ends Both)</b> Each line item must be dashed with FPEB. Order Example: W3030-FPEB. In 20-20, use Attachments to apply FPEB to each cabinet.
	<b>with Matching Interior</b> Matching Interior nomenclature is only available for individual cabinets. There is no nomenclature to order a full kitchen with Matching Interior Furniture Plywood. See individual cabinet instructions.	<b>MIFP (Matching Interior Furniture Plywood)</b> Each line item must be dashed with MIFP. Order Example: W3030-MIFP. In 20-20, use Attachments to apply MIFP to each cabinet.
All Plywood Construction	<b>APC</b> Use APC in the header of your written order. Every cabinet on this order will receive APC. Use Styles & Pricing in 20-20 to choose APC.	<b>AP (All Plywood)</b> Each line item must be dashed with AP. Order Example: W3030-AP. In 20-20, use Add-ons to apply AP to each cabinet.
	<b>with Matching Interior</b> Matching Interior nomenclature is only available for individual cabinets. There is no nomenclature to order a full kitchen with Matching Interior All Plywood. See individual cabinet instructions.	<b>MIP (Matching Interior Plywood)</b> Each line item must be dashed with MIP. Order Example: W3030-MIP. In 20-20, use Attachments to apply MIP to each cabinet.
All Plywood Construction with Furniture Ends	All Plywood Construction with Furniture Ends nomenclature is only available for individual cabinets. There is no nomenclature to order a full kitchen with All Plywood Construction Furniture Ends. See individual cabinet instructions.	<b>APFC (All Plywood Furniture Ends Both)</b> Use APC in the header of your written order and each line item must be dashed with APFC. Order Example: W3030-APFC. In 20-20, use Styles & Pricing to choose APC, then use Attachments to apply APFC to each cabinet.
	<b>with Matching Interior</b> Matching Interior nomenclature is only available for individual cabinets. There is no nomenclature to order a full kitchen with Matching Interior Furniture All Plywood. See individual cabinet instructions.	<b>MIAPFC (Matching Interior All Plywood Furniture Ends)</b> Use APC in the header of your written order and each line item must be dashed with MIAPFC. Order Example: W3030-MIAPFC. In 20-20, use Styles & Pricing to choose APC, then use Attachments to apply MIAPFC to each cabinet.

Construction Option Comparison Chart

Feature	Description	Standard Construction	Plywood Ends	APC	FPEB	APFC
Face Frame	3/4" solid hardwood	●	●	●	●	●
End Panel Construction	1/2" 45 lb. engineered wood	●				
	1/2" plywood		●	●		
	3/4" plywood				●	●
End Panel Finish	2 mil Viraguard both sides	●				
	Matching Viraguard interior (Open cabinets)	●	●			
	Matching wood veneer interior (Furniture cabinets and WA27)	●	●	●	●	●
	2 mil Viraguard interior and wood veneer exterior		●		●	
	Birch wood veneer interior and matching wood veneer exterior			●		●
Floor and Tops	1/2" 45 lb. engineered wood	●	●		●	
	1/2" plywood			●		●
Wall Backs	1/8" engineered wood with 2 mil Viraguard interior	●	●		●	
	3/16" matching wood veneer (Furniture and open cabinets)		●	●	●	●
	3/16" plywood with birch wood veneer			●		●
	3/8" V-groove wood veneer (Beaded frame country cabinets)	●	●	●	●	●
Base & Tall Back	3/8" 45 lb. engineered wood with 2 mil Viraguard interior	●	●		●	
	3/16" matching wood veneer (Furniture cabinets)	●	●	●	●	●
	3/8" V-groove wood (Beaded frame country cabinets)	●	●	●	●	●
	3/8" plywood with birch wood veneer			●		●
	1/8" engineered wood with 2 mil Viraguard Interior (Easy Reach and Base Angle cabinets)	●	●		●	
Hanging Rails	3/16" plywood with birch wood veneer (Easy Reach and Base Angle cabinets)			●		●
	3/4" solid wood base rails and 1/2" solid wood wall rails	●	●	●	●	●
Toe Kicks	1/2" 45 lb. engineered wood recessed into end panels	●	●		●	
	1/2" plywood with birch wood veneer			●		●
Corner Blocks I-Beam Braces	1/2" engineered wood, MDF or plywood dadoed into face frame, end panels and back hanging rails	●	●	●	●	●
Shelves	3/4" 45 lb. Engineered Wood with 2 mil Viraguard and vinyl edgeband. Fully adjustable	●	●		●	
	3/4" wood veneer with prefinished edgeband. Fully adjustable. (Furniture cabinets)	●	●		●	
	3/4" plywood with birch wood veneer and edgeband. Fully adjustable			●		●
Drawers	3/4" Hardwood four sided dovetail drawer box with 3/16" plywood floor	●	●	●	●	●
Drawer Runners	Full extension ball bearing undermount with 75 lb. load capacity, self-closing design and controlled closing mechanism	●	●	●	●	●
Hinges	Whisper Touch™ soft closing, quiet, six-way adjustable hinge or knife hinge	●	●	●	●	●
Shelf Clips	Clear positive locking design	●	●	●	●	●
	Satin chrome shelf rests (Kitchen wall, open and furniture cabinets)	●	●	●	●	●
Wood Finish	DuraKraft Plus™ finish	●	●	●	●	●
Wood Species	Alder	●	●	●	●	●
	Birch	●	●	●	●	●
	Cherry	●	●	●	●	●
	EverCore™	●	●	●	●	●
	Hickory	●	●	●	●	●
	High Gloss Laminate		●	●	●	●
	Laminate		●	●	●	●
	Maple	●	●	●	●	●
	Oak	●	●	●	●	●
	Woodgrain Laminate		●	●	●	●